

# NORTHERN SPIRIT

by Coachmen



## CAMPING SIMPLIFIED

### Camping Simplified Model Naming

First 2 numbers = Approximate box length  
 Second 2 numbers = Approximate weight  
 Letters = Floor plan description

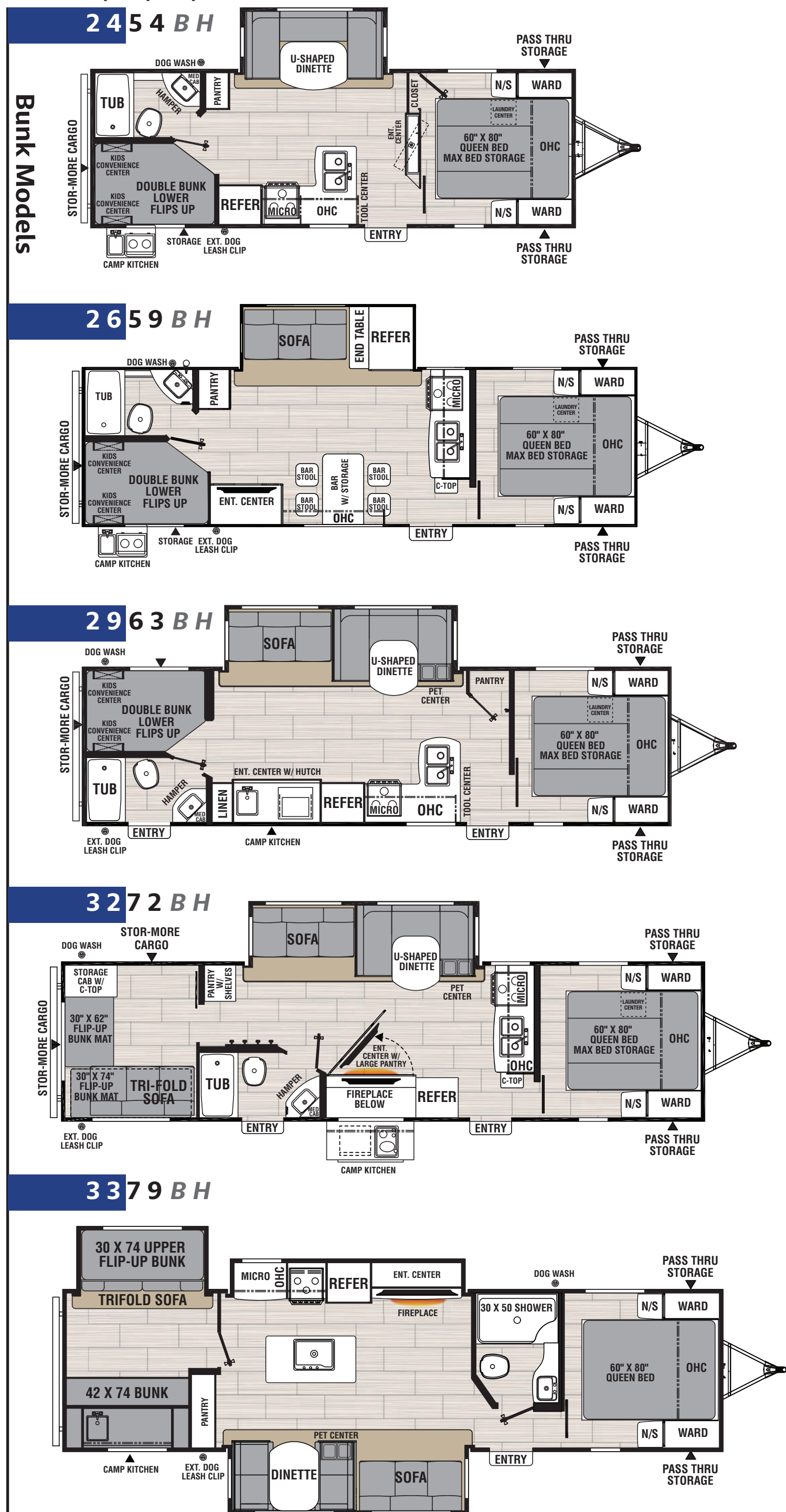

Non Bunk Models

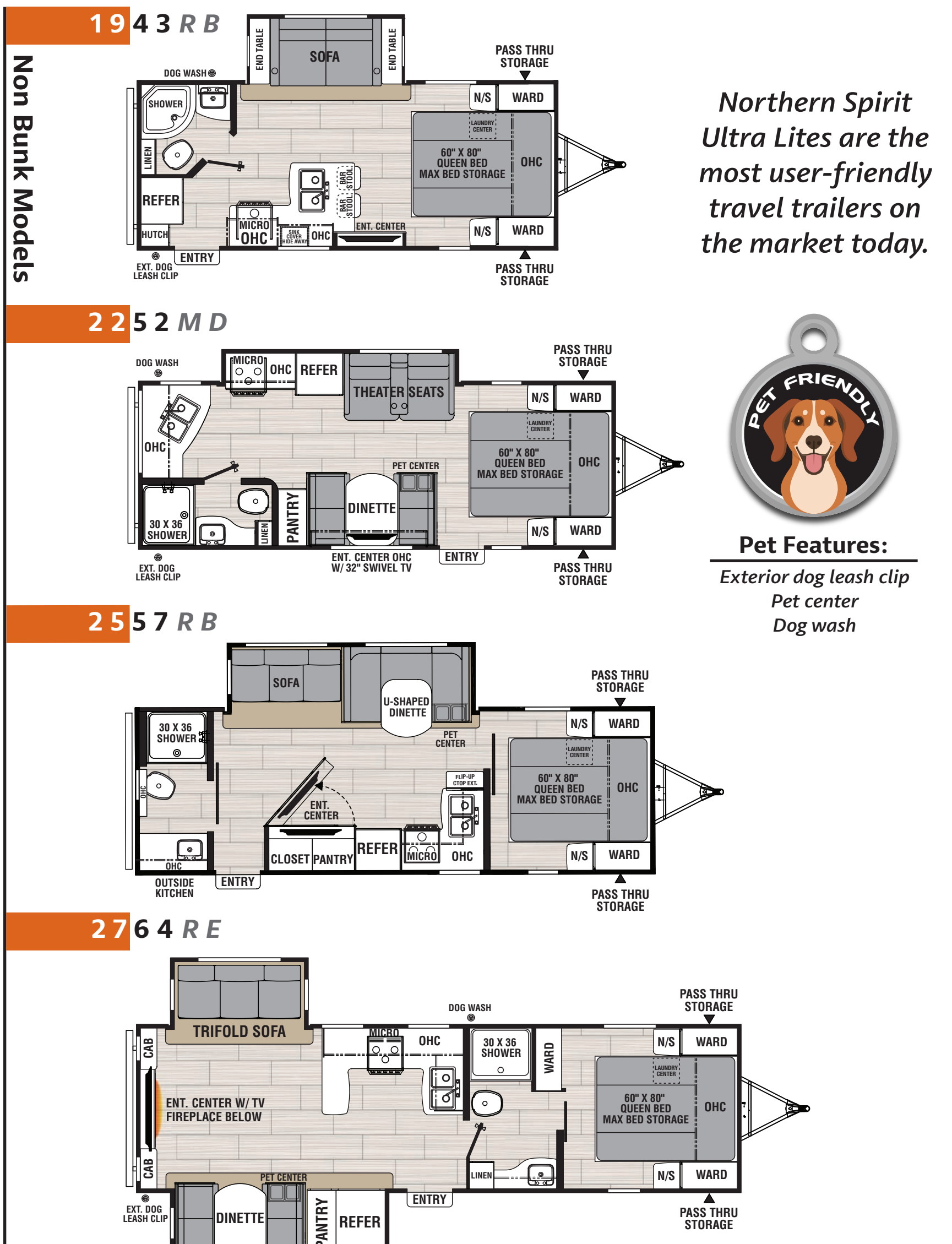

Northern Spirit Ultra Lites are the most user-friendly travel trailers on the market today.

**Pet Features:**  
 Exterior dog leash clip  
 Pet center  
 Dog wash

	Bunk Models					Non-Bunk Models			
Models	2454BH	2659BH	2963BH	3272BH	3379BH	1943RB	2252MD	2557RB	2764RE
Hitch Weight (lbs.)	770	850	760	928	1,094	520	696	648	750
Carrying Capacity (lbs.)	2,098	1,382	1,192	2,602	1,552	1,574	2,438	1,758	898
UVW (lbs.)	5,552	6,218	6,408	7,198	8,248	4,926	5,162	5,842	6,702
Ext. Length (Bumper to Hitch)	28' 9"	31' 8"	33' 11"	36' 4"	36' 11"	23' 10"	26' 11"	29' 3"	32' 9"
Ext. Height (Incl. A/C)	11' 1"	11' 1"	11' 1"	11' 4"	11' 4"	11' 1"	11' 1"	11' 1"	11' 4"
Awning Length	20'	20'	18'	20'	11' & 8'	15'	18'	18'	12'
Fresh Water Capacity (gal.)	49	49	49	49	49	49	49	49	49
Grey Water Capacity (gal.)	33	66	33	66	66	33	33	66	33
Waste Water Capacity (gal.)	33	33	33	33	33	33	33	33	33
Wheel Size	14"	14"	14"	15"	15"	14"	14"	14"	15"

**Coachmen**  
 Recreational Vehicles  
 A division of Forest River, Inc.

To learn more about Coachmen RV and our products and see how Coachmen is making the easy life easier, visit [www.coachmenrv.com](http://www.coachmenrv.com).

COA COACHMEN OWNERS ASSOCIATION FREE MEMBERSHIP [www.coachmenowners.com](http://www.coachmenowners.com)

FOREST RIVER BUY LOCAL [www.ForestRiverBuyLocal.com](http://www.ForestRiverBuyLocal.com)

Find us on Facebook

RV CARE

Learn More Scan this barcode using a QR Reader on your smart phone to learn more about Forest River.

FOREST RIVER A Berkshire Hathaway company.

All information contained in this poster is believed to be accurate at the time of publication. However, during the model year, it may be necessary to make revisions and Forest River, Inc., reserves the right to make all such changes without notice, including prices, colors, materials, equipment and specifications as well as the addition of new models and the discontinuance of models shown on this poster. Therefore, please consult with your Coachmen dealer and confirm the existence of any materials, design or specifications that are material to your purchase decision. ©2021 Northern Spirit by Coachmen RV, a Division of Forest River, Inc., a Berkshire Hathaway company. All rights reserved. 12/21

GWR (Gross Vehicle Weight Rating) - is the maximum permissible weight of the unit when fully loaded. It includes all weights, inclusive of all fluids, cargo, optional equipment and accessories. For safety and product performance do NOT exceed the GWR.  
 GVWR (Gross Axle Weight Rating) - is the maximum permissible weight, including cargo, fluids, optional equipment and accessories that can be safely supported by a combination of all axles.  
 UVW (Unloaded Vehicle Weight) - is the typical weight of the unit as manufactured at the factory. It includes all weight at the unit's axle(s) and tongue or pin and LP Gas. The UVW does not include cargo, fresh potable water, additional optional equipment or dealer installed accessories.  
 \*Estimated average based on standard build optional equipment.  
 CCC (Cargo Carrying Capacity) - is the amount of weight available for fresh potable water, cargo, additional optional equipment and accessories. CCC is equal to GVWR minus UVW. Available CCC should accommodate fresh potable water (8.3 lbs per gallon). Before filling the fresh water tank, empty the black and gray tanks to provide for more cargo capacity.  
 \*\*Estimated average based on standard build optional equipment.  
 Each Forest River RV is weighed at the manufacturing facility prior to shipping. A label identifying the unloaded vehicle weight of the actual unit and the cargo carrying capacity is applied to every Forest River RV prior to leaving our facilities. The load capacity of your unit is designated by weight, not by volume, so you cannot necessarily use all available space when loading your unit.